

# Kingsley Suite 1 & 2

Canham Turner - Ground floor

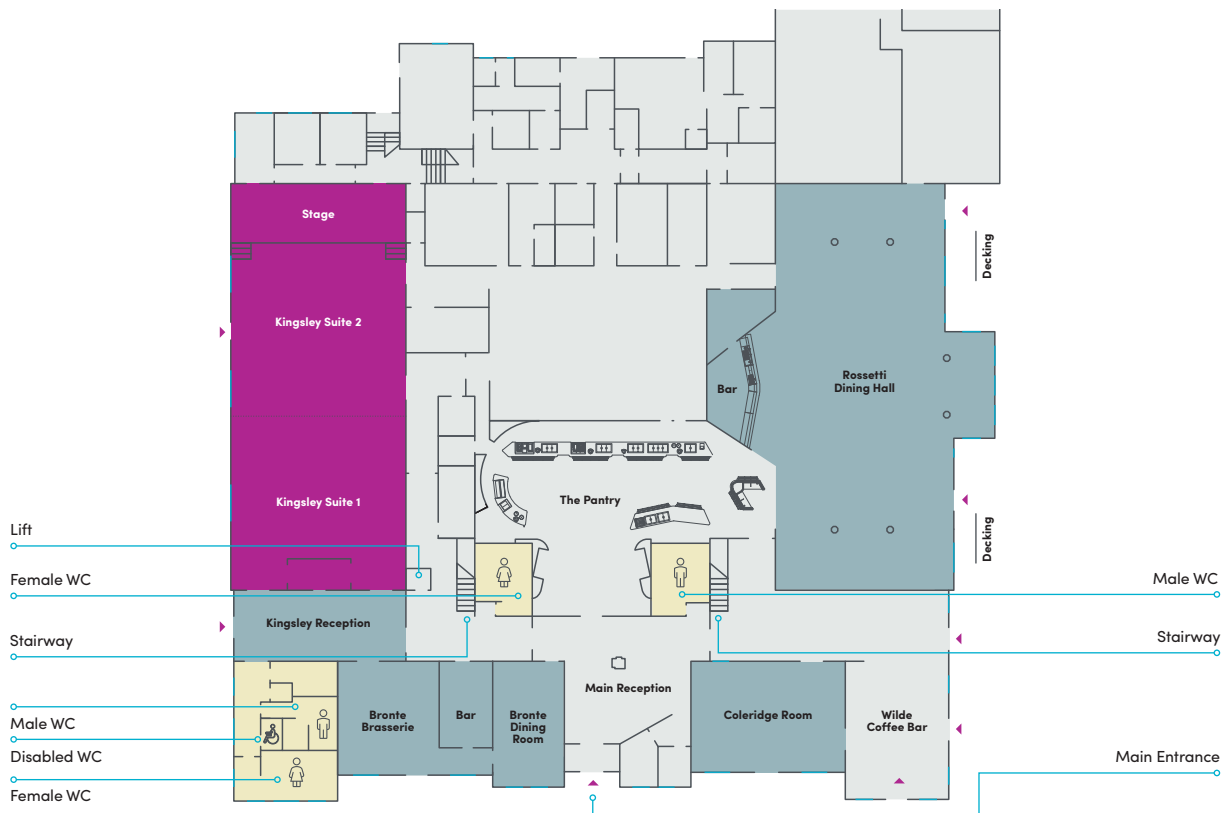

## Dimensions

**Length:** 23m  
**Width:** 12m  
**Area:** 276sq m



## Lighting

- Dimmers
- Natural daylight
- Blackout facility
- Colour controllable lights
- Recess lighting
- Lighting rig



## Power & communications

- Screen, projector & Sound system
- Laptop Connection Points: HDMI, VGA, AUX & ethernet cable
- Sound/Light technicians booth
- 13 amp sockets - x50
- 32 LAN connection points
- Wireless & wired internet access



## Access

- Double Doors - 2 sets at the front
- Double Doors - 1 set at the side



## Flooring

- Carpeted flat flooring
- Stage (4.1m x 12m)



## Stage

A full-sized, raised stage provides the perfect platform for presentations and performances



## Private bar access

Situated across from the Bronte Brasserie, the suite provides guests with easy access to a fully licensed bar



## Cutting-edge tech

The suite features colour-controllable lights and has full AV facilities



## Organisers Area

A stylish reception desk with telephone; PC access and cloakroom facilities is available for organisers in the Kingsley Reception

## Capacities

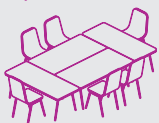

**Boardroom style:** 48

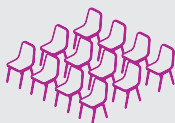

**Theatre style:** 300

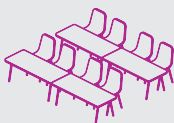

**Classroom style:** 140

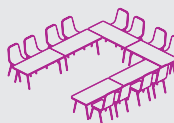

**Horseshoe style:** 48

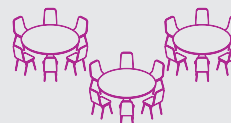

**Cabaret:** 200

Need some more information?

Call the team **01482 465341**

or email [beyondevents@hull.ac.uk](mailto:beyondevents@hull.ac.uk)